

# 製品情報

## Open Guide Bush N550

品目番号 5002079

### Suitability

Open guide bush with tapered inside edges on both sides.

- Allows universal use.
- When used in combination with shaft diameter  $d_w$  ISO-h3, preloading of the rotary stroke bearing is guaranteed.
- The ball cage can project out of the guide bush on both sides to permit longer stroke paths (note minimum contact length).
- Minimal installation space when used with Mini Range ball cages N 502.

### 技術データ

material	Steel
material number	1.3505 (AISI E52 100)
heat treatment	through-hardened
constant working temperature	150

### 寸法

shaft diameter ( $d_w$ ) - Mini	3
Inner diameter of guide bush ( $d_1$ )	5
Length of guide bush ( $l_1/L$ )	15
Outer diameter of guide bush ( $d_B$ )	7
outer diameter tolerance	n4

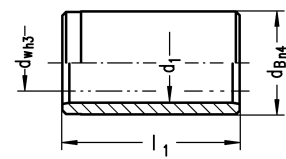

### Features

- Guide bore diameter  $d_1$  is finely honed to ISO tolerance IT 3,  $R_z$  0.5 – 1.5  $\mu m$  depending on diameter.
- Roundness within 1/3 ISO-IT 3.
- Cylindricity within IT 1.
- Radial run-out of a shaft inserted under preloading is within 0.0005 mm.
- Tapered inside edges on both sides ensure smooth running.
- Outside diameter  $d_B$  n4 with radial run-out error within IT 4, ground to guide bore diameter  $d_1$  lead-in taper on one side.
- See catalog page 37-41 for instructions on installation and servicing.