

製品情報

Open Guide Bush N550

品目番号 5002065

Suitability

Open guide bush with tapered inside edges on both sides.

- Allows universal use.
- When used in combination with shaft diameter d_w ISO-h3, preloading of the rotary stroke bearing is guaranteed.
- The ball cage can project out of the guide bush on both sides to permit longer stroke paths (note minimum contact length).
- Minimal installation space when used with Mini Range ball cages N 502.

技術データ

material	Steel
material number	1.3505 (AISI E52 100)
heat treatment	through-hardened
constant working temperature	150

寸法

shaft diameter (d_w) - Mini	3
Inner diameter of guide bush (d_1)	5
Length of guide bush (l_1/L)	20
Outer diameter of guide bush (d_B)	7
outer diameter tolerance	n4

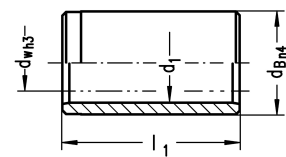

Features

- Guide bore diameter d_1 is finely honed to ISO tolerance IT 3, R_z 0.5 – 1.5 μm depending on diameter.
- Roundness within 1/3 ISO-IT 3.
- Cylindricity within IT 1.
- Radial run-out of a shaft inserted under preloading is within 0.0005 mm.
- Tapered inside edges on both sides ensure smooth running.
- Outside diameter d_B n4 with radial run-out error within IT 4, ground to guide bore diameter d_1 lead-in taper on one side.
- See catalog page 37-41 for instructions on installation and servicing.